

Installation Manual Double DIN Kit 381200-02

DOUBLE DIN HEAD UNIT PROVISION

- 1 Cut the center bar rib.
- 2 Slide the appropriate bracket into the radio housing aligning the holes in the radio housing with the holes on the bracket. (Figure A)
- 3 Slide the DDIN radio unit into the DDIN bracket/radio housing assembly and secure the unit to the kit using the screws supplied with the head unit. (Figure B)
- 4 Snap the DDIN Trim Plate into the radio housing. (Figure B)

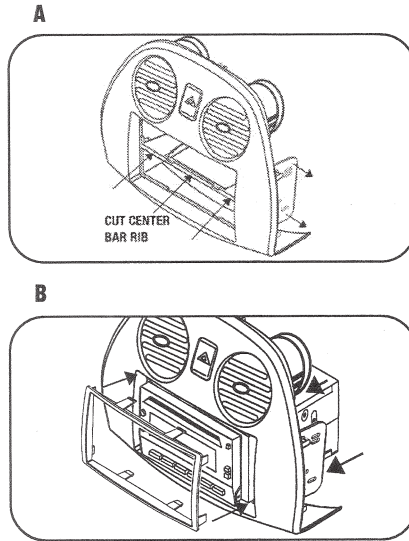

Installation Manual Double DIN Kit 381200-02

Mitsubishi Eclipse 2006->

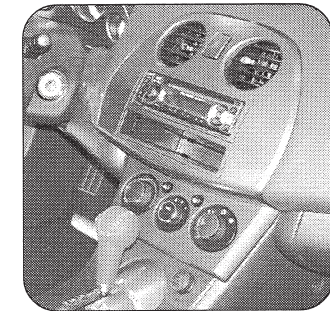

KIT COMPONENTS

A) Radio Housing B) ISO Brackets C) ISO Trim Plate D) DDIN Brackets E) Pocket F) DDIN Trim Plate

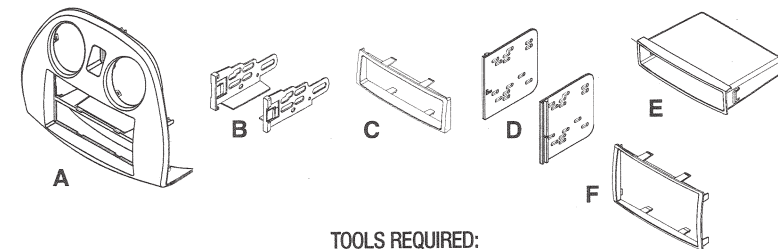

TOOLS REQUIRED:

Phillips Screwdriver | Small Flat Blade Screwdriver



Compatible with double DIN devices

All installation work must be performed by a qualified professional installer only.
The manufacturer / dealer is not liable for any kind of incidental or indirect damages.

2006 MITSUBISHI ECLIPSE

1 Disconnect the negative battery terminal to prevent an accidental short circuit.

2 Unclip and remove the trim panel including the radio a/c vents (Figure A)

3 Remove (4) Phillips screws securing radio chassis to dash to remove. (Figure B)

4 Unclip and remove the a/c vents from the factory radio trim panel. (Figure C)

5 Unclip and remove the hazard switch from the factory radio trim panel. (Figure D)

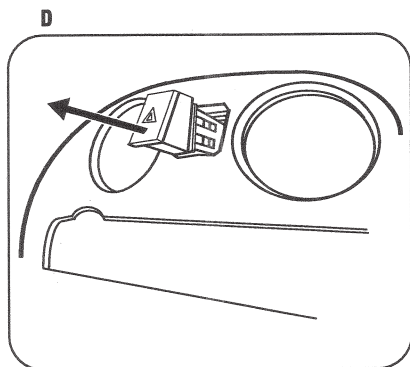
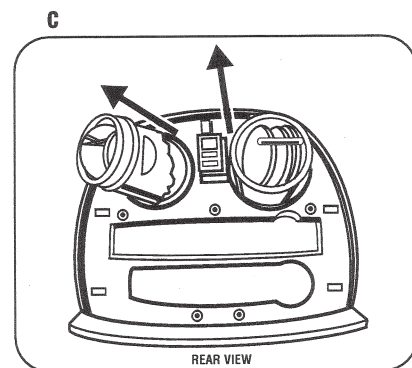
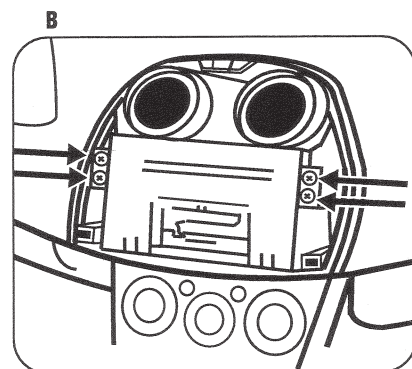
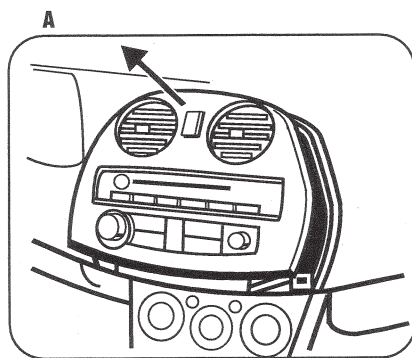

RADIO HOUSING ASSEMBLY

1 Clip the a/c vents into the radio housing. (Figure A)

2 Clip the hazard switch into the radio housing. (Figure B)

