



# Installation Manual Double DIN Kit

black (rubber-touch)	391001-08
silver (standard)	381001-88
black (standard)	381001-09-1

## • Alfa MiTo

Compatible these double DIN devices

### Double DIN Navigation

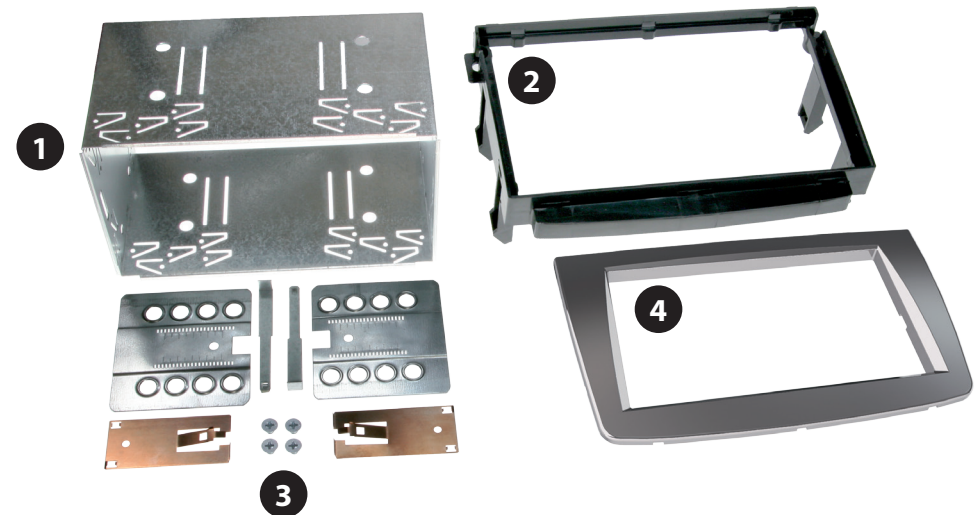

Double DIN Kit contents

- (1) Metal Frame
- (2) Mounting Frame
- Installation Kit (3)
- Trim Frame (4)

## Installation Manual Double DIN Kit 391001-08



1. Insert special radio release keys in the holes of the OEM Radio



2. Remove the OEM Radio

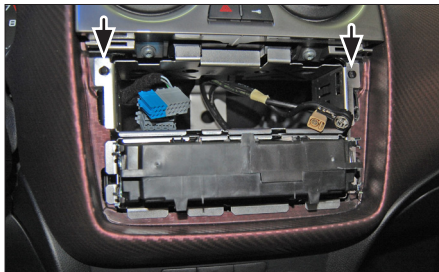

3. Remove the original metal holder inside the dashboard, which is fixed by 2 screws (see arrows)

4. Push the new mounting bracket into the dashboard and fix it with the 2 original screws.

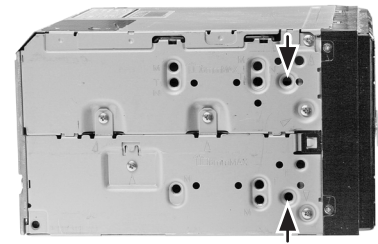

Mount the metal brackets with the double DIN head unit

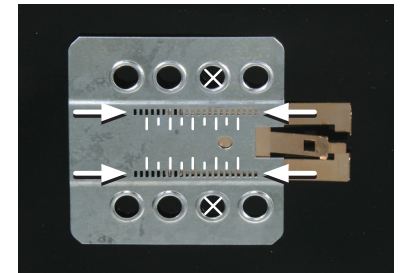

*The position of the copper coloured holder can be adjusted to your needs for perfect fit. (see sample)*



5. Push the Metal Frame into the fascia plate, place both into the dashboard.

Connect all required circuit points and push the double DIN head unit in the metal frame until it snaps in.

Place the trim frame.

Reinstall everything in reverse order to finish installation.

*All installation work must be performed by a qualified professional installer only.  
The manufacturer / dealer is not liable for any kind of incidental or indirect damages.*