

6. Cut away plastic hooks (plain to surface) at the rear side of OEM panel

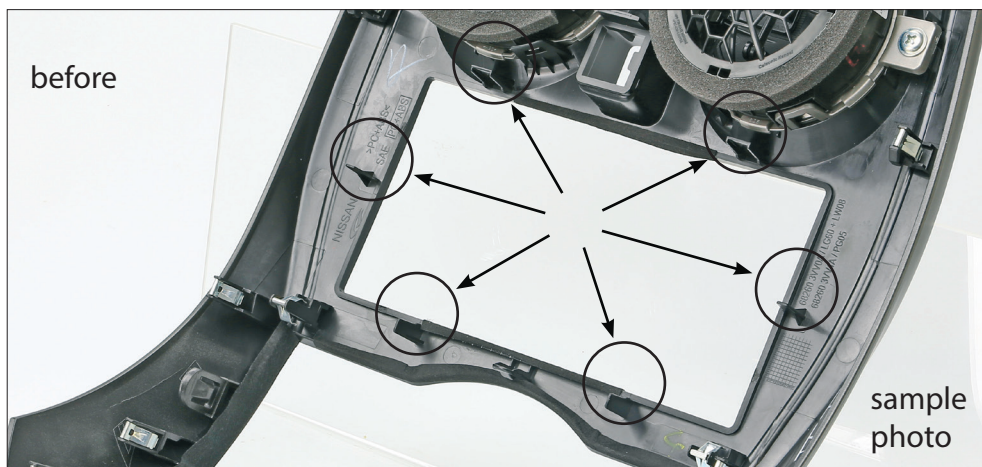

7. Connect all required circuit points and mount head unit to dashboard

Re-install everything in reverse order to finish installation

All installation work must be performed by a qualified professional installer only.
The manufacturer / dealer is not liable for any kind of incidental or indirect damages.



Double DIN Installation Manual

colour: piano-black

2-DIN 381210-19-1

• Nissan Pulsar 2015->

2-DIN with pocket 281210-19-1

2-DIN with Inbay® pocket 241210-19-1

Compatible with these double DIN devices

Double-DIN Navigation

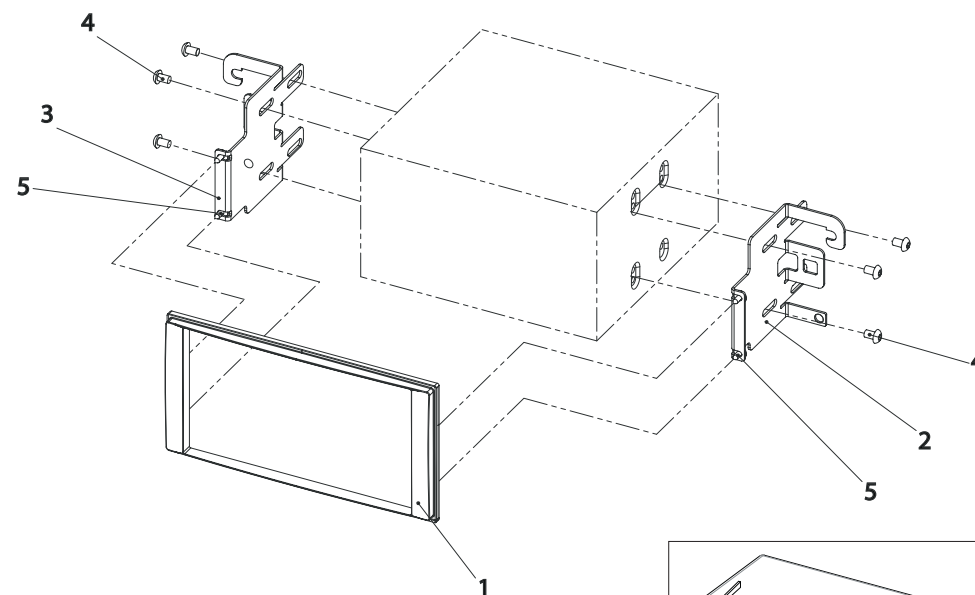

- (1) Facia Plate
- (2) Mounting bracket right
- (3) Mounting bracket left
- (4) flat headed screw
- (5) self-tapping screw with collar

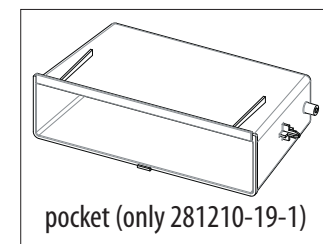

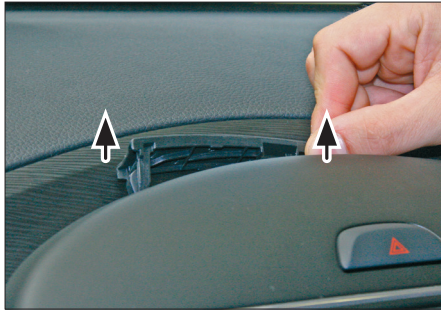

1. Unclip cover at the top of dashboard panel

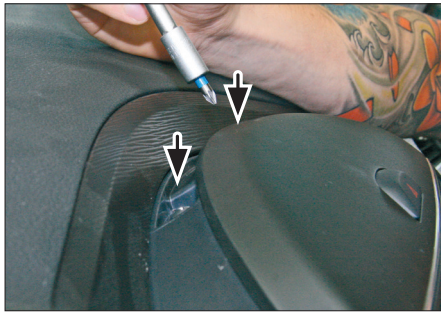

2. Remove all screws on the top of the panel

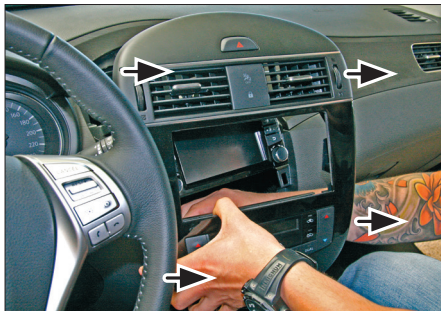

3. Unclip and remove panel by pulling it towards your direction (unplug all cables like hazard light switch / air condition control unit etc. carefully!)

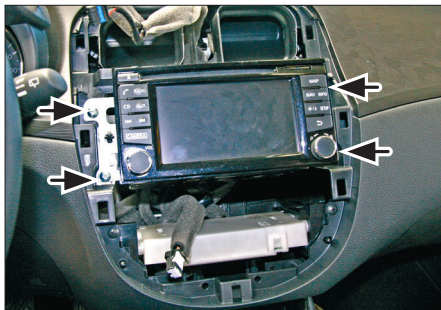

4. Remove 4 screws of OEM head unit



5. 2-DIN

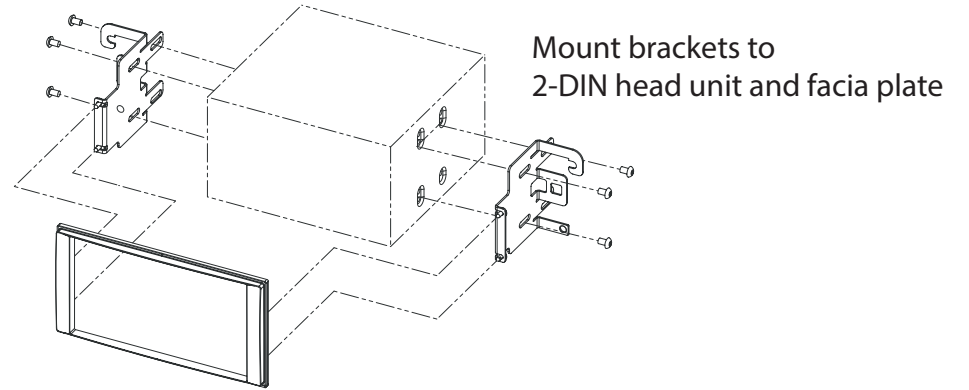

5a. 2-DIN with pocket (for 1-DIN radios)

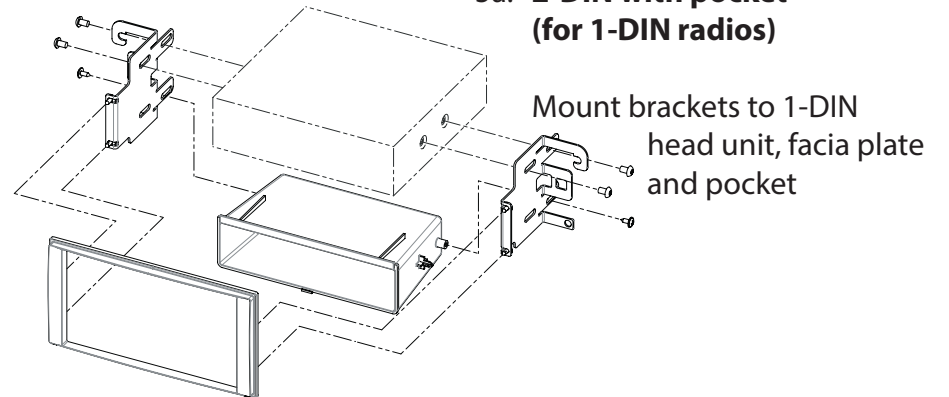

5b. 2-DIN with Inbay® pocket (for 1-DIN radios)

